

Safety Coupling  
with keyway and collet clamp

optional  
nickel-plated version  
optional full stainless  
steel version

# KBK/EPK

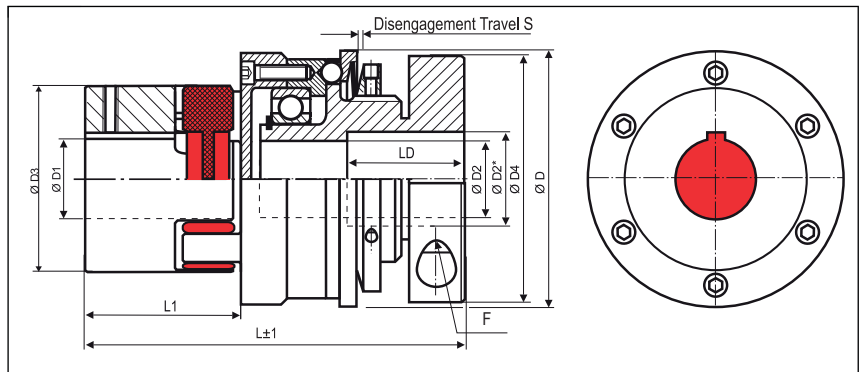

Order Code

**KBK/EPK - 24 - 126.5 - N16H7 - 14H7 - 20Nm - C or D - 2**

Type	Size	Length	ØD1 (H7)	ØD2 (H7)	Disengagement Torque	Torque Range
						C = Single Position D = Multi Position Engagement

Size	Dimensions (mm)									Technical Data								
	Ø D	L	Ø D1	Ø D2	Ø D3	Ø D4	F	L1	S	max. speed (1/min)	Mass (kg)	Moment of Inertia J (kg cm²)	Torque 98 Sh TKN (Nm)	Torque Range		Misalignment		
	Outer Ø	Length	Bore Size (H7) min~max	Bore Size (H7) min~max			Screw ISO4762 TA (Nm)							1 TKN (Nm)	2 TKN (Nm)	radial Δ Kr (mm)	axial Δ Ka (mm)	angular Δ Kw (°)
-14	49	65	6-16	6-16	30	40.5	M4 5.1	24	0.7	11690	0.22	0.5	12.5	3-7	5-10	0.09	+1.0 -0.5	0.9
-19	64	100	10-24	10-20 14#	40	56	M6 15	41	1.2	8950	0.77	3.2	17	5-15	10-30	0.06	+1.2 -0.5	0.9
-24	79	126.5	16-28	12-28 21#	55	66	M8 36	50	1.2	7630	1.34	8.2	60	12-35	20-60	0.10	+1.4 -0.5	0.9
-28	94	142	20-38	14-35 27#	65	82	M10 72	59	2	6030	3	26	160	50-130	65-150	0.11	+1.5 -0.7	0.9
-38	119	160	20-45	30-50 41#	80	110	M12 125	67	2	4980	5.7	86	325	60-200	150-300	0.12	+1.8 -0.7	0.9
-42	129	195	20-55	35-56 46#	95	122	M12 125	76	2	4440	10.5	186	450	80-250	200-500	0.14	+2.0 -1.0	0.9

<b>Bores</b>	> Ø D2 and ≤ D2* only over LD
<b>Material</b>	hubs: aluminium spider element: polyurethane 98 Sh A (red)
<b>Keyway</b>	optional acc. DIN 6885 biggest bore marked with a #
<b>Temperature Range</b>	-30 °C ~ 90 °C

<b>Size</b>	14	19	24	28	38	42
<b>D2*</b>	20	26	31	38	57	62
<b>LD</b>	20	28	38	34	42	56